

OpenStudyBuilder – a Metadata Data and Study Definition Repository

End-to-end automation from structured protocol to submission deliverables using concept-based standards



OpenStudyBuilder Solution

- A Clinical Metadata Repository (as a graph database)
- An API layer
- The OpenStudyBuilder Application (web application)



Study Specifications & Standards Management

- Single metadata source for key deliverables e.g. protocol, CRF, SDTM, ADaM, CTR, TFL
- Standardization through controlled terminology, dictionaries, templates
- Built-in compliance with external and internal standards
- A higher degree of end-to-end consistency due to re-usability and linkage
- Facilitation of more automation and content reuse through open interface (API)
- Metadata driven creation of structured protocol content

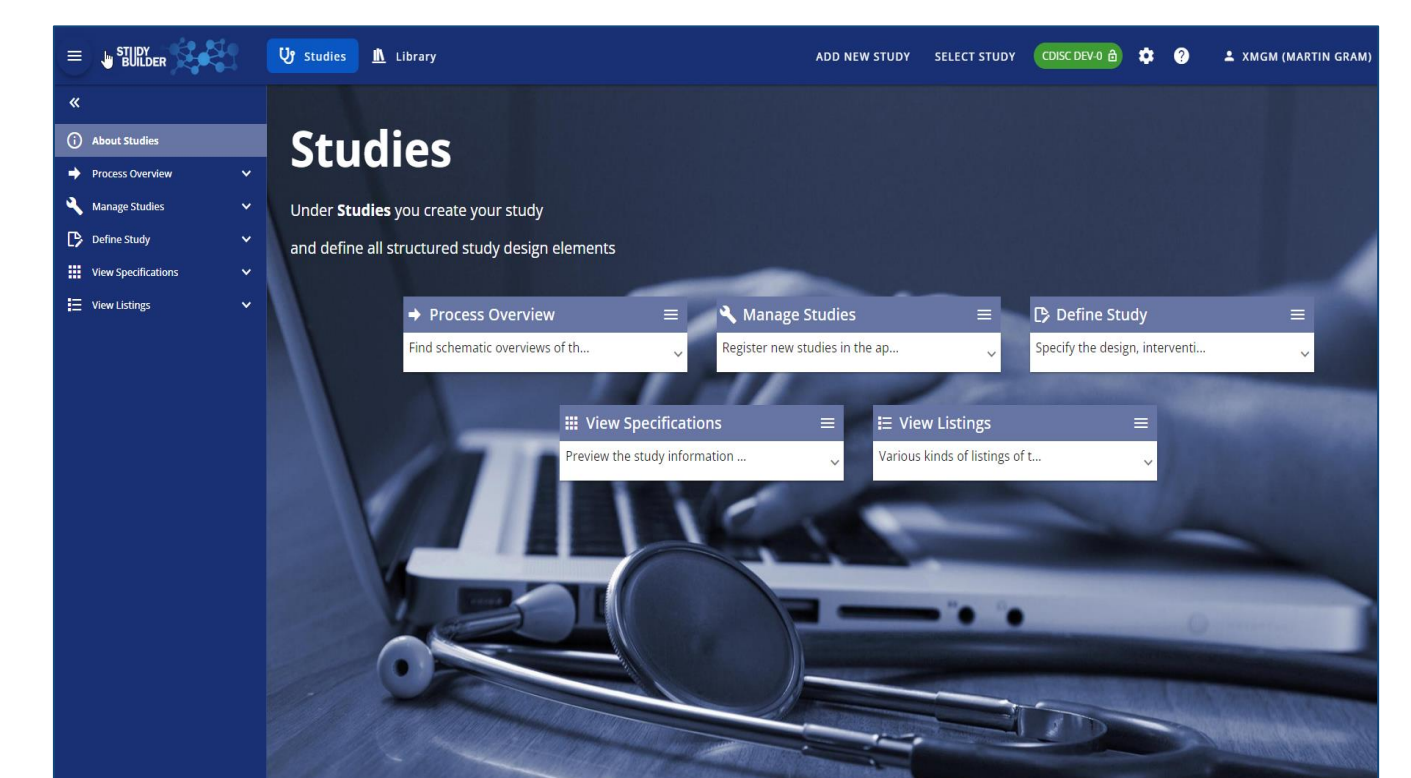
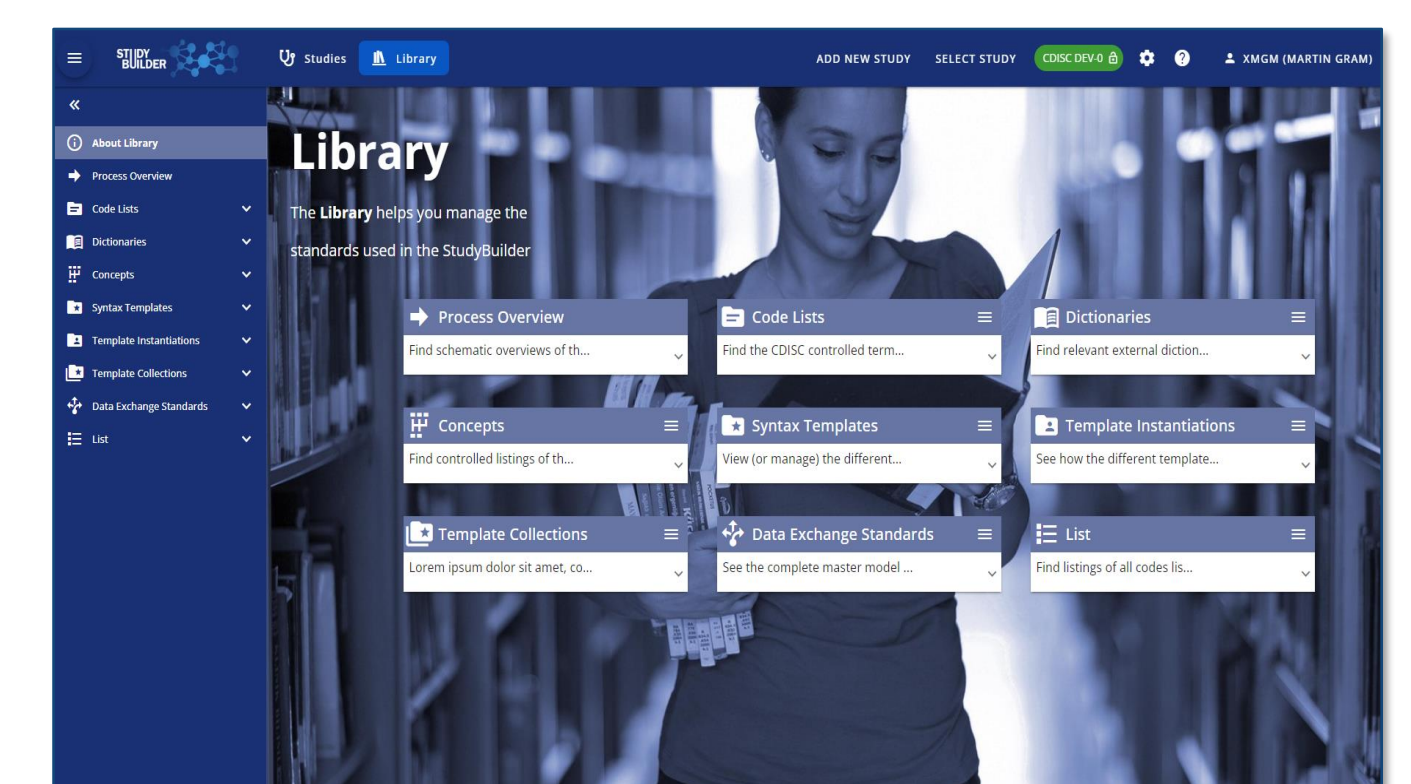

Standards & Study Definitions
Protocol
Case Report Forms
Controlled Terminology
Dictionaries
Schedule of Activities
...

API
&
DDF
API

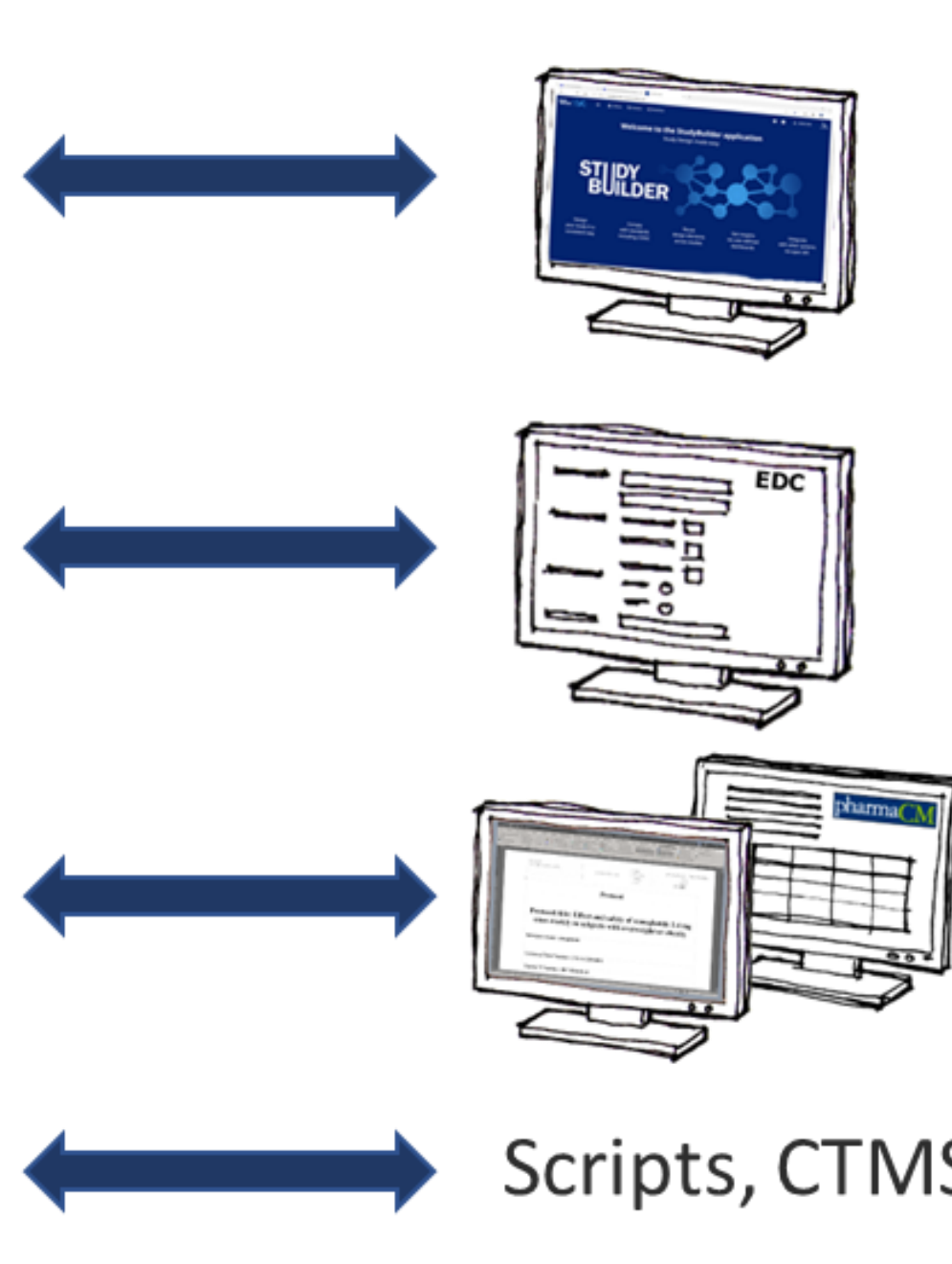

OpenStudyBuilder Application

Electronic Data Capture

Protocol

Scripts, CTMS, other MDR, SCE, TLF Builder, ...

Connectivity to Systems

- Full connectivity to any kind of systems through APIs
- Maintenance of standards, like CRFs standardization and utilization in downstream EDC system
- Protocol harmonization through standards

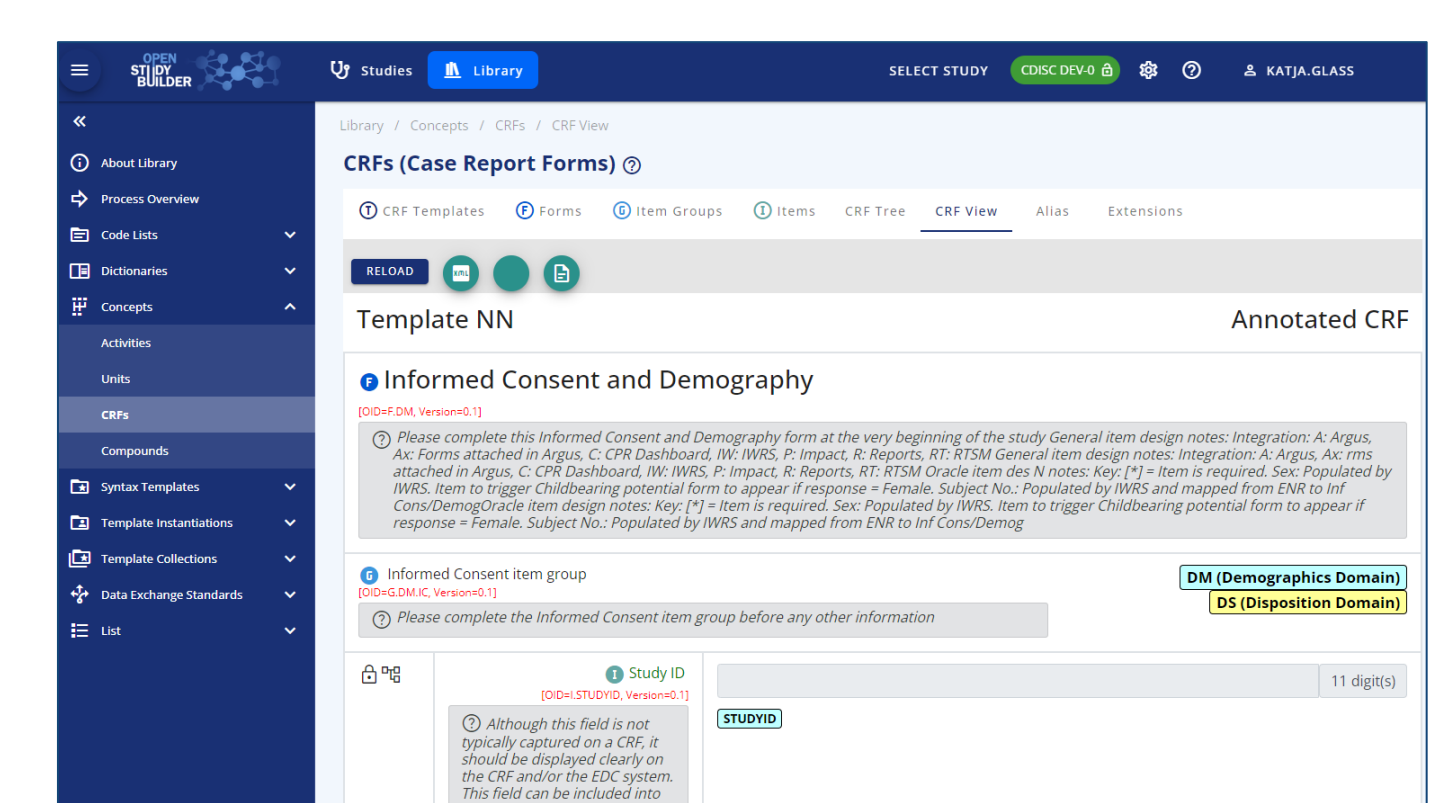
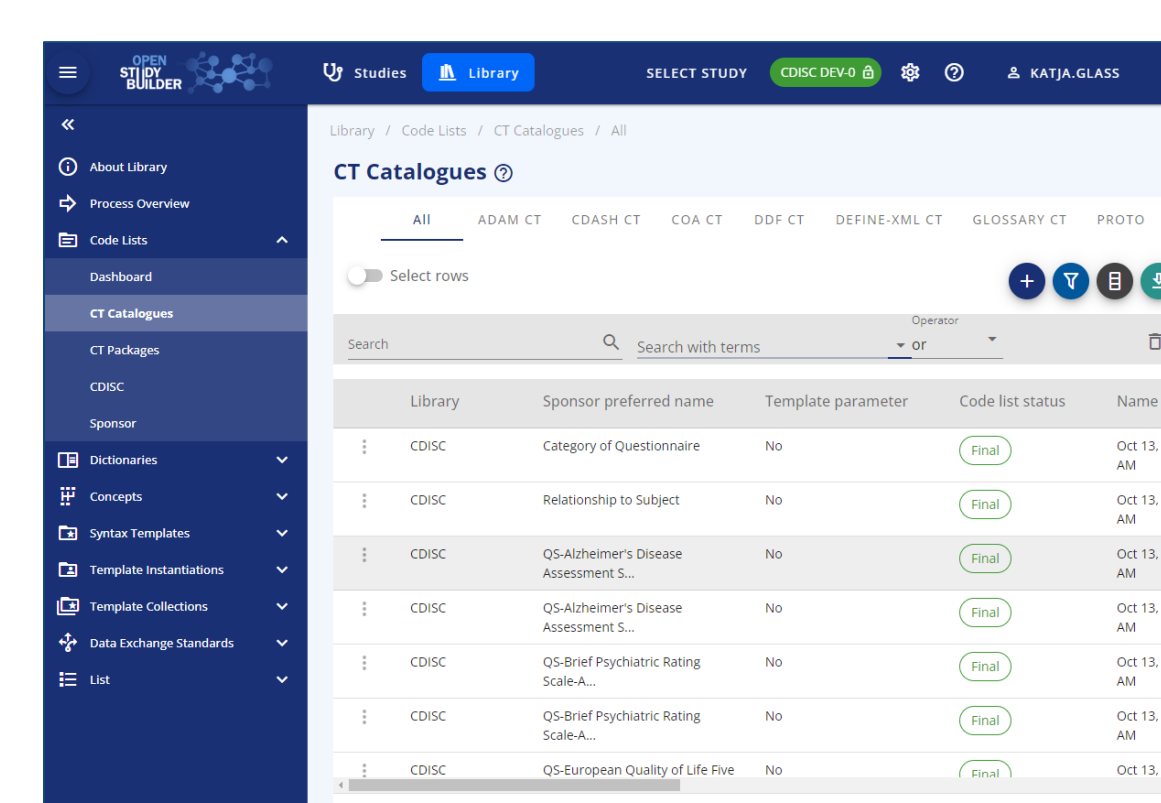
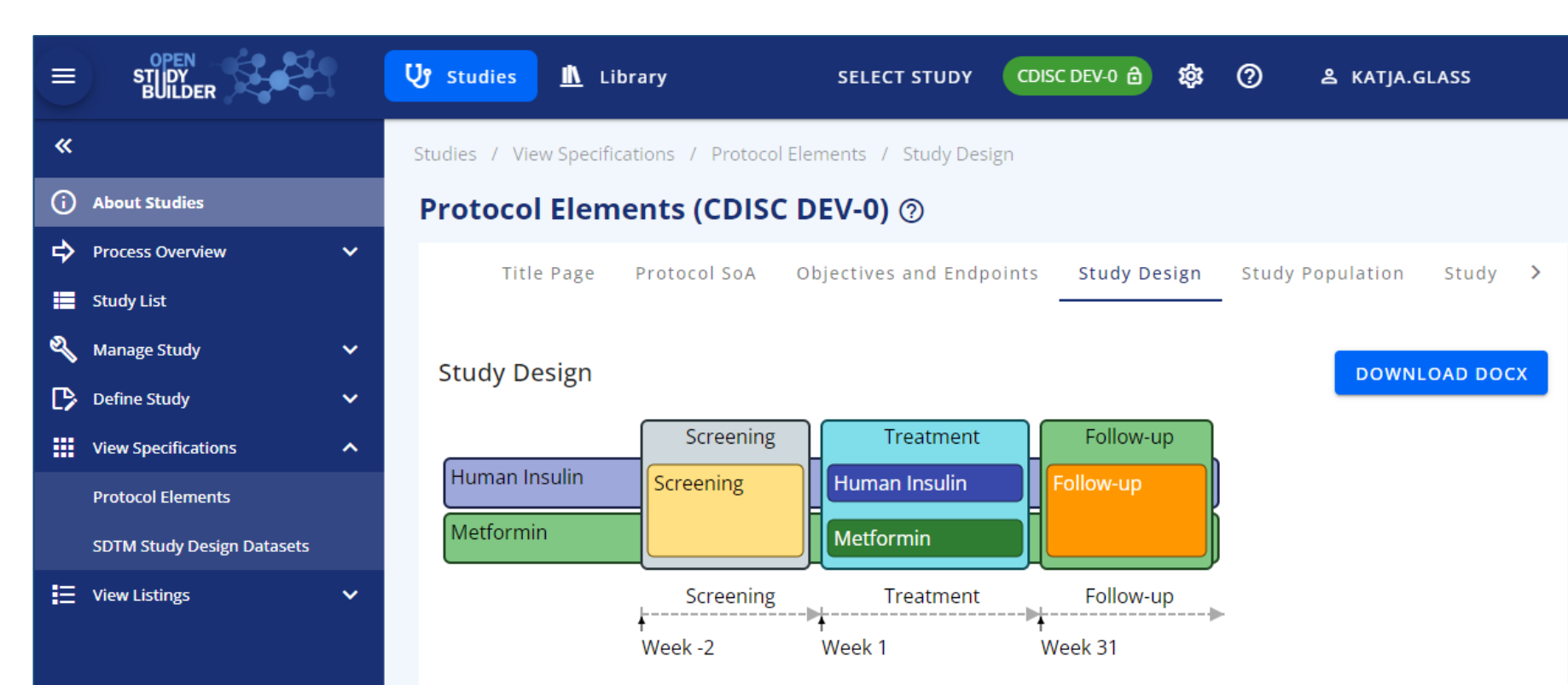
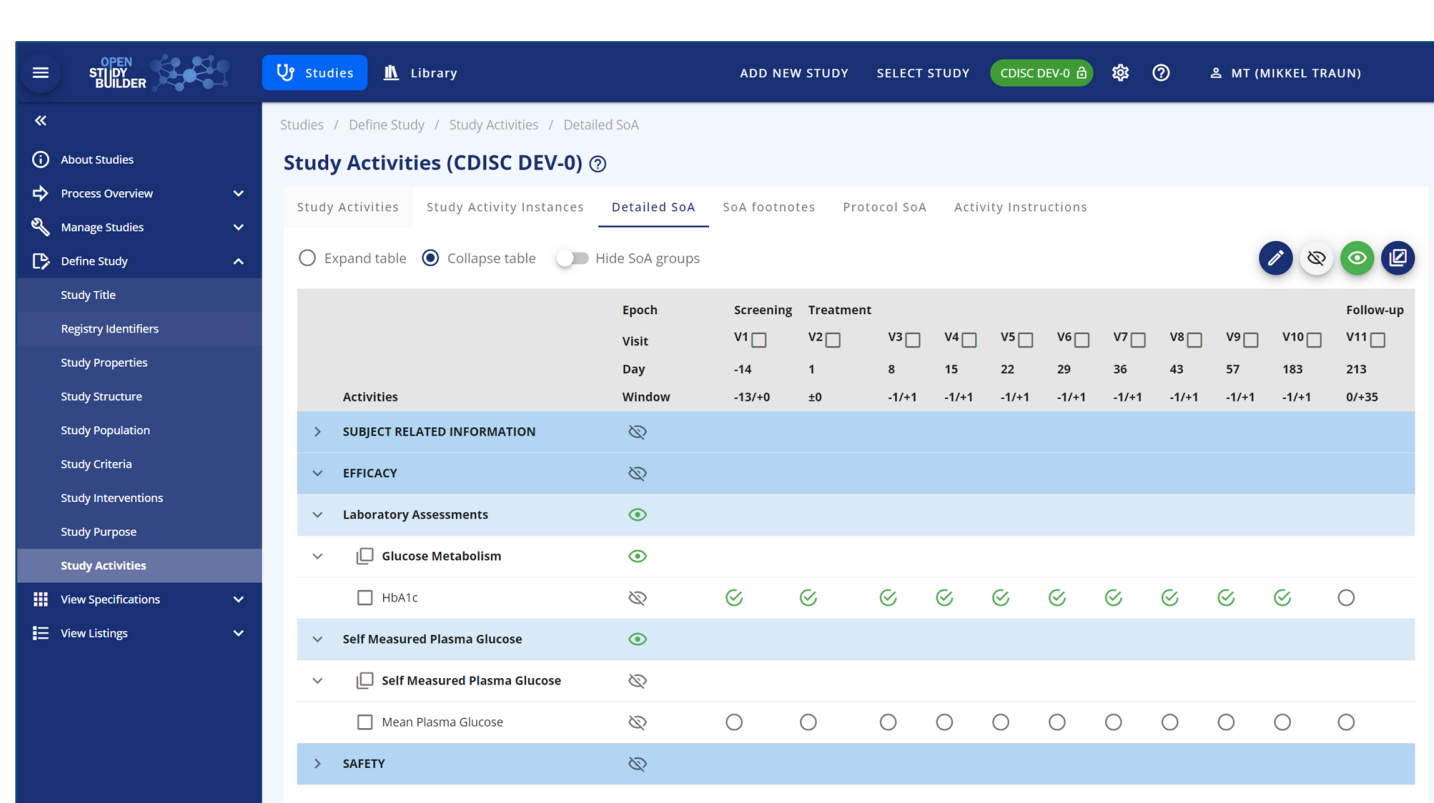

Open Source

- OpenStudyBuilder is shared as open source under COSA by Novo Nordisk
- Collaborate with TransCelerate as a Digital Data Flow (DDF) compatible solution
- Collaborate with CDISC, e.g. for Biomedical Concept Development & Enhancements

